



DESIGN DEVELOPMENT

SEPTEMBER 14, 2023

# HUNTINGTON NATIONAL BANK MARKET SQUARE

# SITE INFORMATION

## 500 Liberty Avenue, Pittsburgh, PA

- Parcel ID: 0001-C-00224-0000-00
- Former McDonald's location

## Zoning District:

- GT-A" Golden Triangle District, Subdistrict A
- Market Square Historic District

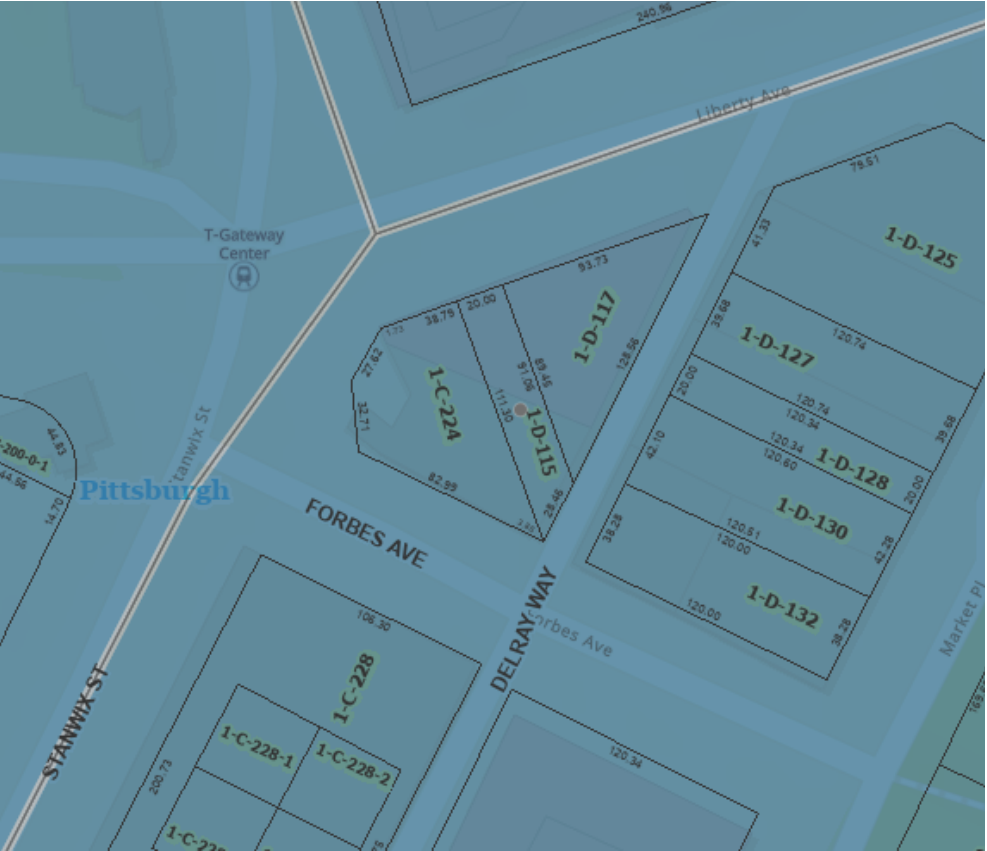

## **DEVELOPMENT ACTIVITY**

### **Previous Activity:**

Development team attended Pre-Application Meeting with City Staff - May 26, 2023

Vocon attended on-site meeting with Historic Review staff - May 31, 2023

### **Upcoming Activity:**

Huntington's development team to formally submit a Zoning Design Review Application by the end of the week.

- Historic Review Commission.
- Possible Board of Zoning Adjustments, dependent on proposed signage and change of use.
- Planning Commission.

Building Permits to follow.



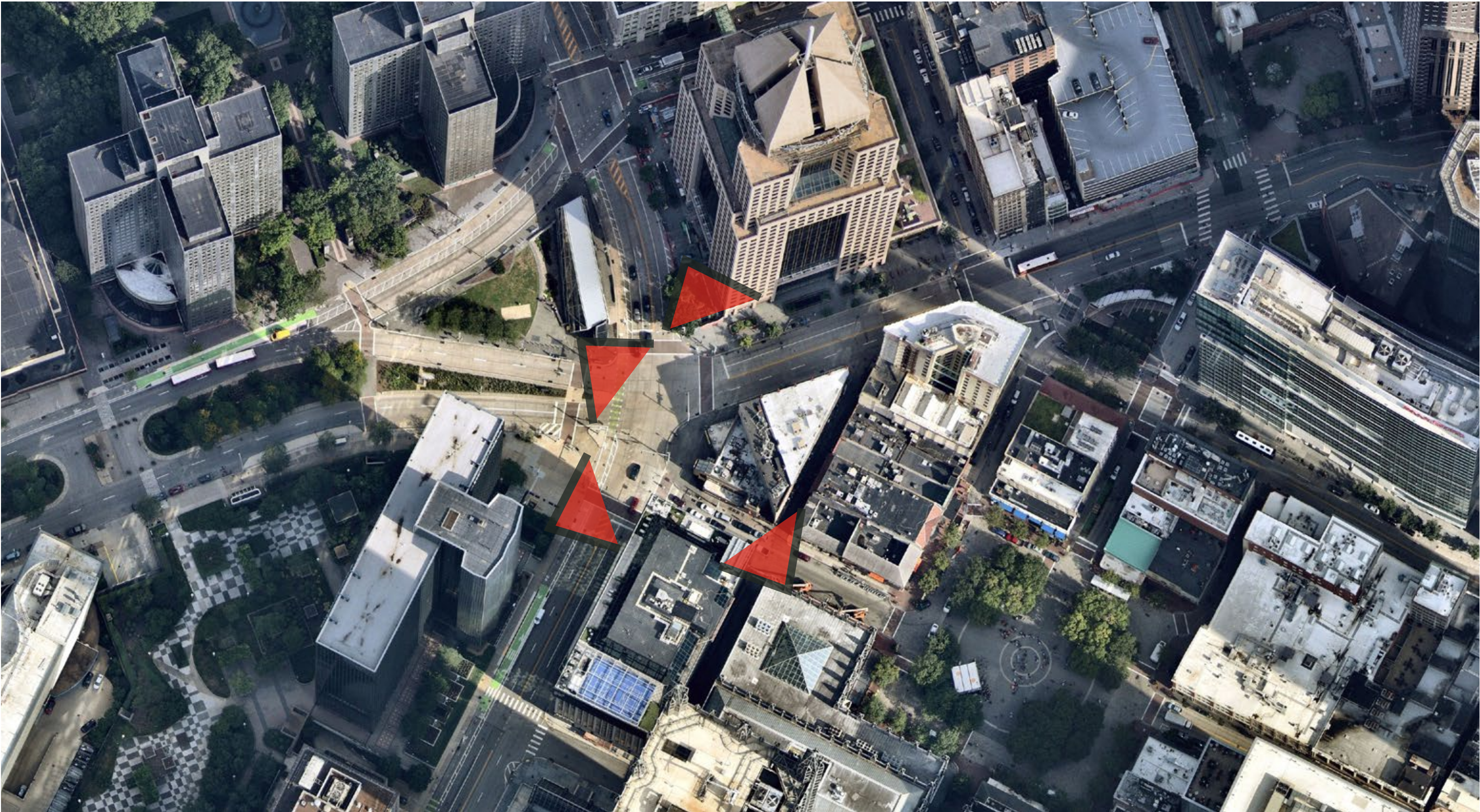









GENERAL NOTES:

1. HUNTINGTON'S IMPROVEMENTS ARE INTENDED TO BE ADDED TO THE EXISTING STRUCTURE WITH THE ABILITY TO REMOVE FROM THE BUILDING AT SUCH A TIME THAT THEIR TENACY TERMINATES.
2. HUNTINGTON WILL MAINTAIN EXISTING MASONRY.
3. CURRENT SCOPE INCLUDES BUILDING A NEW RETAIL BRANCH ON FIRST FLOOR. CURRENTLY NO SCOPE ON SECOND FLOOR OR BASEMENT.
4. LIGHTING INTENDED TO INCREASE SAFETY WHILE HIGHLIGHTING THE ARCHITECTURE OF EXISTING BUILDING.

EXISTING METAL ROOF TO BE MAINTAINED AND PAINTED.

METAL GUARD RAIL AND PLANTER AT EXISTING TERRACE

FABRIC AWNINGS

LANDSCAPE AND PLANTERS AT CORNER INSET ON HUNTINGTON LEASE LINE

HNB LOGO (SIGNAGE UNDER SEPARATE COVER) TYPICAL ALL SIGNAGE SHOWN

METAL ENTRY PORTAL INDEPENDENT OF EXISTING BUILDING FACADE LOCATED WITHIN HUNTINGTON LEASE LINE

















GENERAL NOTES:

1. HUNTINGTON'S IMPROVEMENTS ARE INTENDED TO BE ADDED TO THE EXISTING STRUCTURE WITH THE ABILITY TO REMOVE FROM THE BUILDING AT SUCH A TIME THAT THEIR TENACY TERMINATES.
2. HUNTINGTON WILL MAINTAIN EXISTING MASONRY.
3. CURRENT SCOPE INCLUDES BUILDING A NEW RETAIL BRANCH ON FIRST FLOOR. CURRENTLY NO SCOPE ON SECOND FLOOR OR BASEMENT.
4. LIGHTING INTENDED TO INCREASE SAFETY WHILE HIGHLIGHTING THE ARCHITECTURE OF EXISTING BUILDING.



EXAMPLES OF DECORATIVE SCREEN

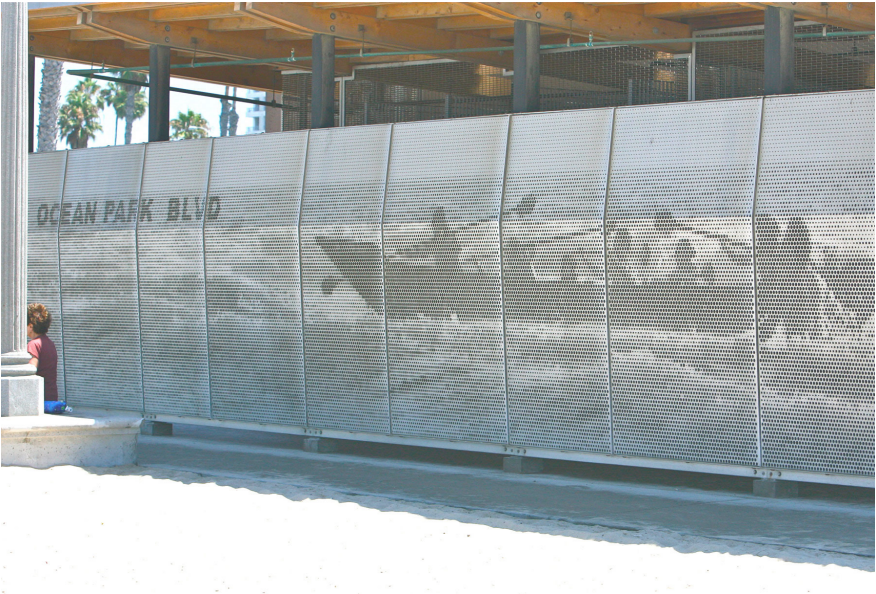



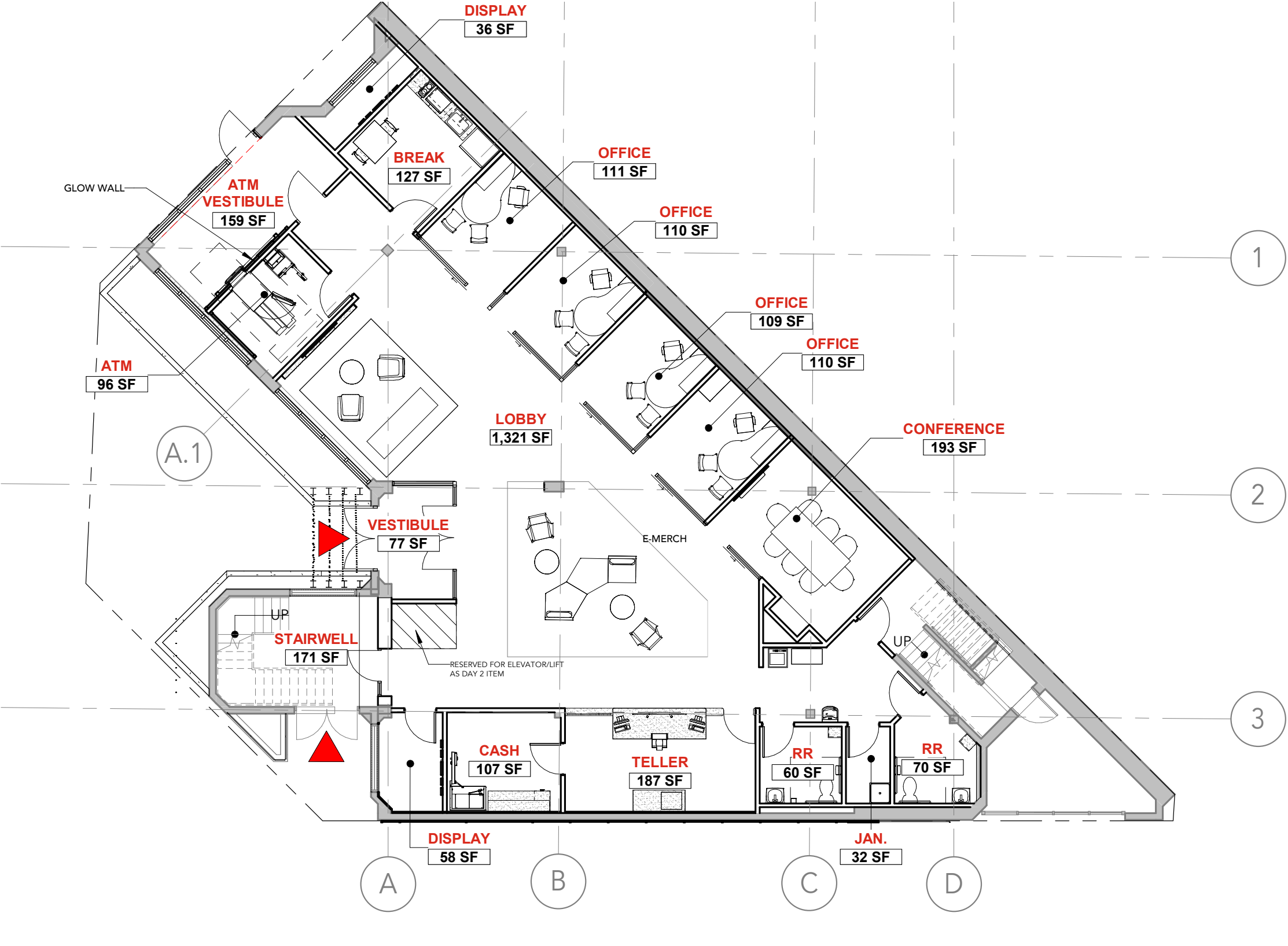



vocon.

**LET YOUR  
SPACES SPEAK.**