

# K&L GATES CENTER

## Full high-rise floors up to 90,606 SF AVAILABLE

### 210 SIXTH AVENUE – Downtown Pittsburgh’s most accessible address



36 <sup>th</sup> Floor (divisible)	14,332	RSF
7 <sup>th</sup> Floor (divisible)	9,954	RSF
3 <sup>rd</sup> Floor	3,269	RSF
<b>3<sup>rd</sup> Floor (furnished)</b>	<b>2,689</b>	<b>RSF</b>

#### Full floor availability

25 <sup>th</sup> Floor	18,561	RSF
23 <sup>rd</sup> Floor	17,890	RSF
22 <sup>nd</sup> Floor	18,309	RSF
21 <sup>st</sup> Floor	17,910	RSF
20 <sup>th</sup> Floor	<u>17,936</u>	RSF
	90,606	RSF

#### **BUILDING LOBBIES & PLAZA FULLY RENOVATED**

- ◆ Numerous on-site amenities including Starbucks, Erin's Deli, and full-service FNB Bank branch
- ◆ On-site property management and 24-hour security
- ◆ Indoor parking – with valet service
- ◆ Morton's Steakhouse, Capital Grille, McCormick & Schmick's, Fairmont Hotel, Market Square and Duquesne Club all within one block
- ◆ Adjacent to Wood Street "T" Station, Cultural District and multiple PAT bus stops





# K&L GATES CENTER

Full high-rise floors up to 90,606 SF Available

## SAMPLE FLOOR PLAN

### Floors 20 through 25

Wood Street

Liberty Avenue

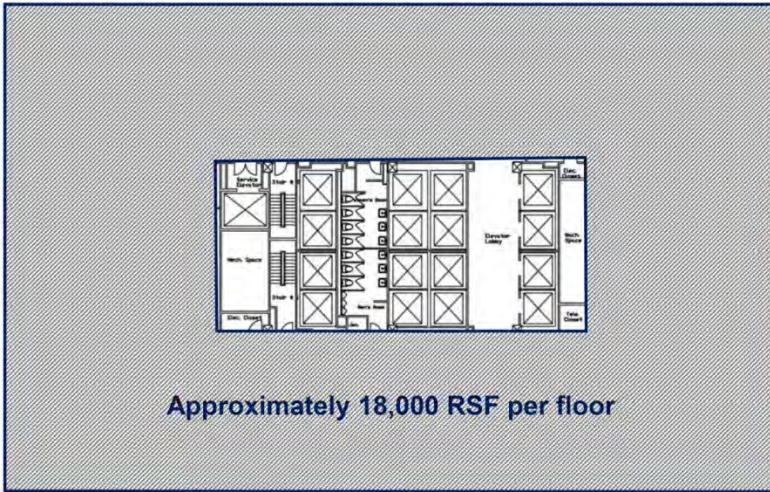

Sixth Avenue

Plaza

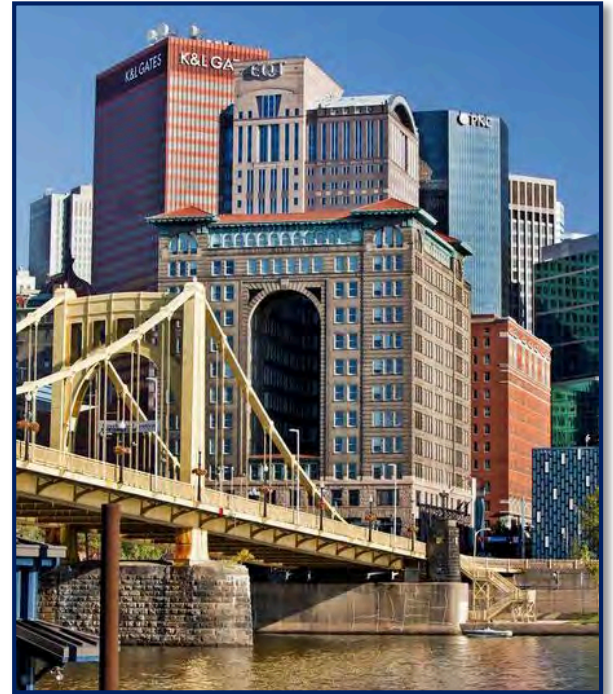

#### FINE DINING

- Capital Grille
- Morton's Steakhouse
- Valozzi's
- McCormick & Schmick's
- Habitat
- The Terrace Room
- Siena Sulla Piazza
- Revel & Roost

#### HOTELS

- Fairmont
- Renaissance
- Hilton Garden Inn
- Omni William Penn
- Wyndham Grand
- Courtyard Marriott
- Hotel Monaco

#### AMENITIES

- Duquesne Club
- Starbucks
- FNB Bank
- Wood Street "T" Station
- GNC

Tom MacDonald, SIOR Senior Managing Director 412.434.1028 tmacdonald@ngkf.com



The information contained herein has been obtained from sources deemed reliable but has not been verified and no guarantee, warrant or representation, either express or implied, is made with respect to such information. Terms of sale or lease and availability are subject to change or withdrawal without notice.